

Requirement for Sloped Seat Joist Hangers

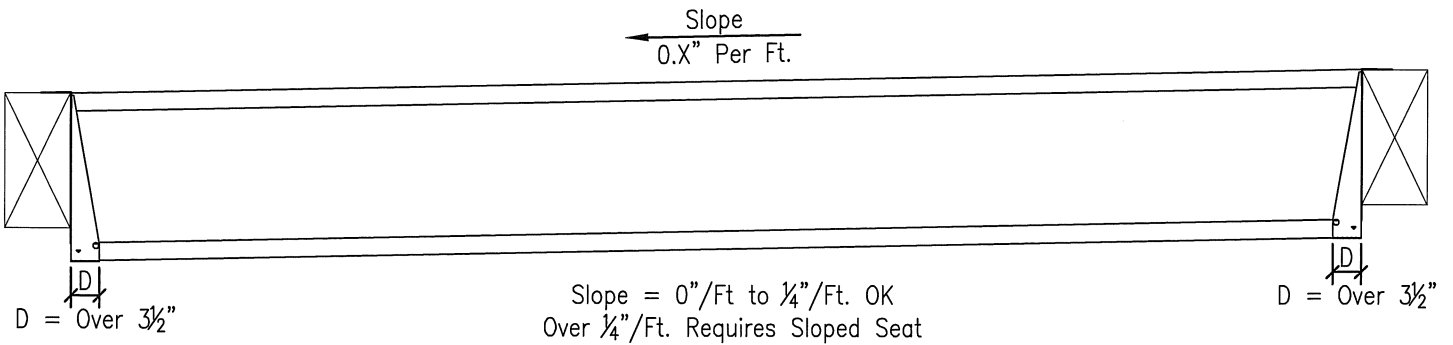

- 1) Look up needed hanger in tables.
 - 2) Get seat dimension (D) from table.
 - 3) Find condition above to match D Dist.
 - 4) Check slope range allowed.
 - 5) Use sloped seat if needed.
- Check tables for which style of hanger that can be sloped & how to specify it.

WEB-i Bevel Plate Requirement

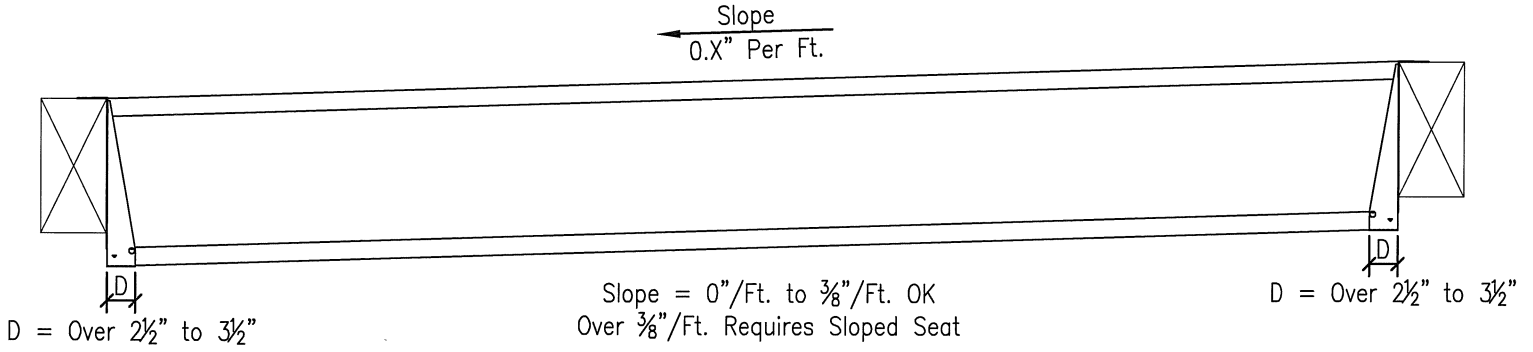
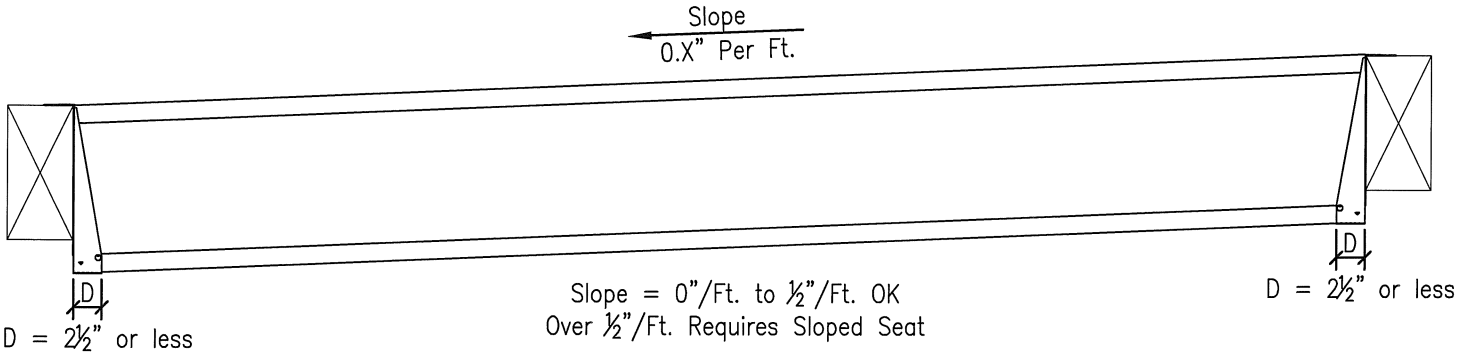
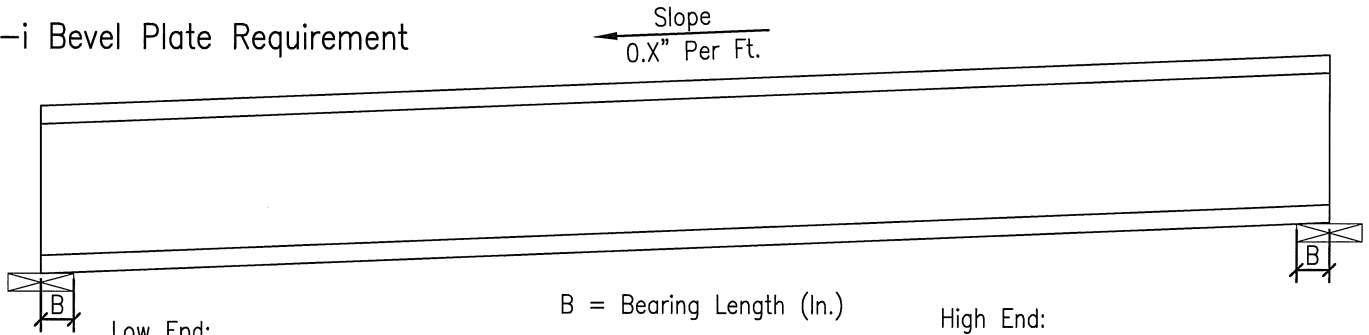

Low End:	
B Dist.	Beveled plate required when slope is equal to or greater than
1 3/4"	1/2"/Ft.
3 1/2"	3/8"/Ft.
5 1/2"	3/16"/Ft.
7 1/4"+	1/8"/Ft.

High End:
Beveled plate required when slope is equal to or greater than 3/8"/Ft.